

30x30x70 Var. F

PDF eckerts3 - Mai 10, 2022

Approved according to SHR SOP 04.07.08 Att. A Vers.4.9 **Kat. 02**
The Signature will not be printed!

GD/LAY eckerts3 - Mai 10, 2022

LAN baroudia - May 13, 2022

PM/LAB obermans - May 19, 2022

IPM behrendr - Jun 01, 2022

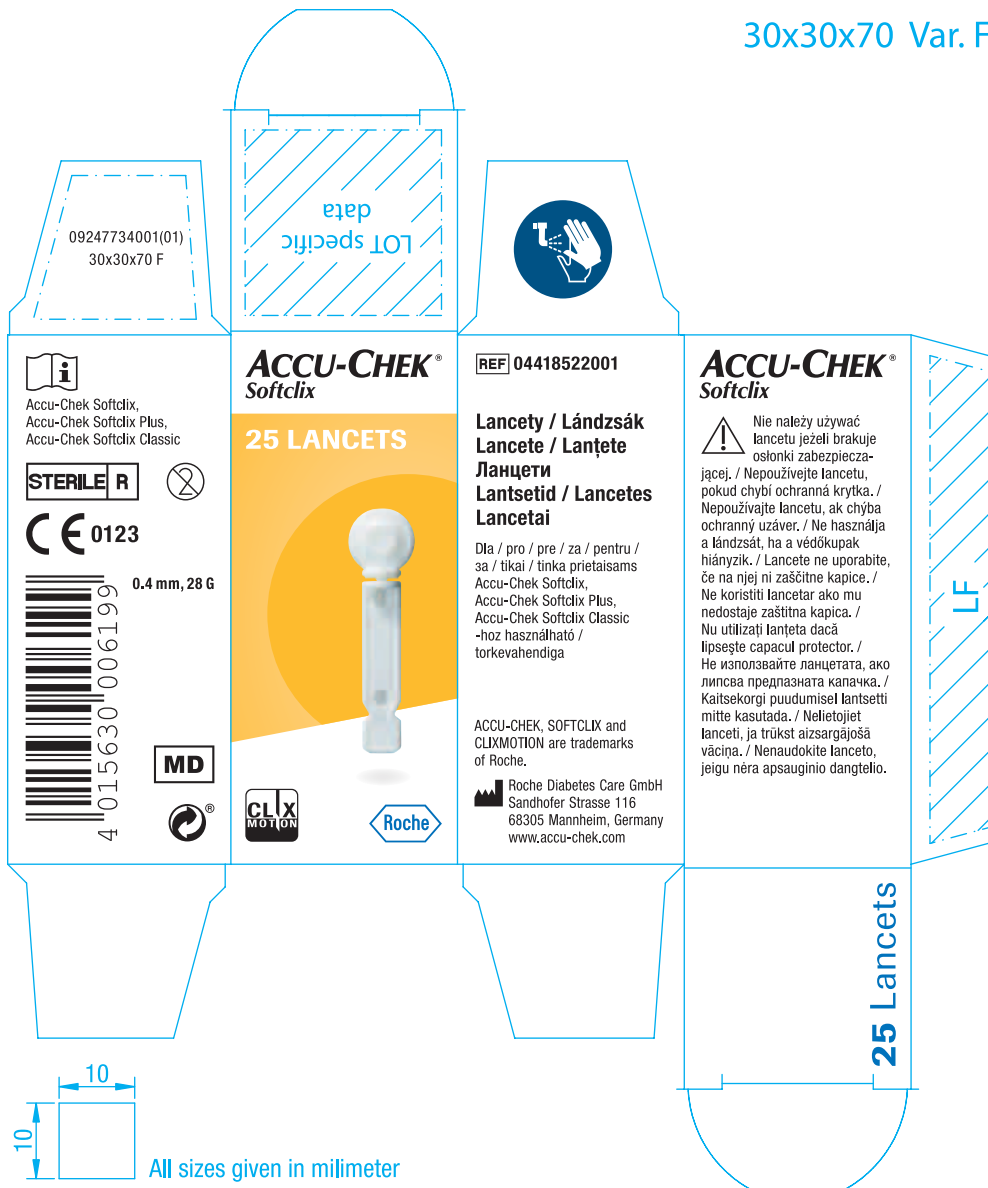

09247734001(01)
30x30x70 F

data
LOT specific



Accu-Chek Softclix,
Accu-Chek Softclix Plus,
Accu-Chek Softclix Classic

STERILE R



CE 0123

0.4 mm, 28 G



4 015630 006199

MD



REF 04418522001

**Lancet / Lándzsák
Lancete / Lanțete
Ланцети
Lantsetid / Lancetes
Lancetái**

Dla / pro / pre / za / pentru /
za / tikai / tinka prietaisams
Accu-Chek Softclix,
Accu-Chek Softclix Plus,
Accu-Chek Softclix Classic
-hoz használható /
torkevahendiga

ACCU-CHEK, SOFTCLIX and
CLIXMOTION are trademarks
of Roche.

 Roche Diabetes Care GmbH
Sandhofer Strasse 116
68305 Mannheim, Germany
www.accu-chek.com

**ACCU-CHEK®
Softclix**



Nie należy używać
lancetu jeżeli brakuje
osłonki zabezpiecza-
jącej. / Nepoužívejte lancetu,
pokud chybí ochranná krytka. /
Nepoužívajte lancetu, ak chýba
ochranný uzáver. / Ne használja
a lándzsák, ha a védőkupak
hiányzik. / Lancete ne uporabite,
če na njej ni zaščitne kapice. /
Ne koristiti lancetar ako mu
nedostaje zaštitna kapica. /
Nu utilizati lanțeta dacă
lipsește capacul protector. /
Ne използвайте ланцетата, ако
липсва предпазната капачка. /
Kaitsekorgi puudumisel lantsetti
mitte kasutada. / Nelietojiet
lanceti, ja trūkst aizsargājošā
vāciņa. / Nenaudokite lanceto,
jeigu nėra apsauginio dangtelio.

LF

25 Lancets

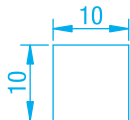

All sizes given in millimeter